

隔離開關
太陽能應用專用
CSP

SWITCH-DISCONNECTORS
for photovoltaic application
CSP

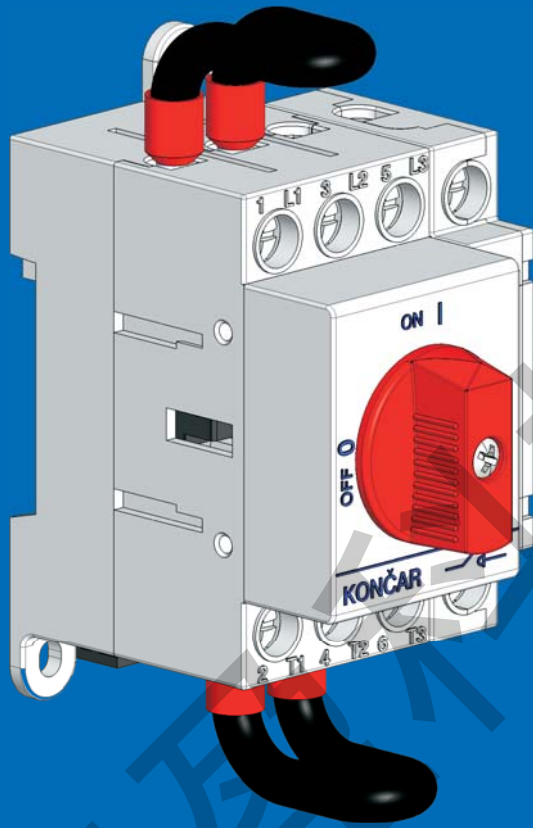

-DC-
隔離開關
SWITCH-DISCONNECTOR
CSP

太陽能模組
PHOTOVOLTAIC
MODULE

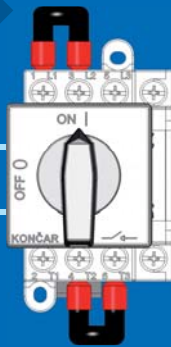

DC / AC
轉換器
INVERTER

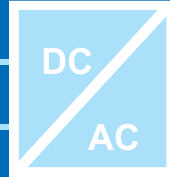

-AC-
隔離開關
SWITCH-DISCONNECTOR

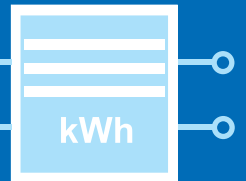

74049



KONČAR

基於再生能源及太陽能板的發展,也連帶帶動了用於切斷直流電路之隔離開關的發展。

CSP系列之隔離開關具有雙斷路系統,符合IEC 60364-7-712對太陽能設備之絕緣要求。

CSP系列的隔離開關可以滿足使用類別DC21B,額定操作電壓上至1000V、操作電流上至80A之操作。

隔離開關是設計放置於太陽能電池以及DC/AC轉換器之間的一個裝置。

The development of renewable energy sources on the basis of photovoltaic panels has resulted with the development of switch-disconnectors which are used for switching off DC circuits.

Switch-disconnectors series CSP with double breaking system completely fulfil requirements for isolation according to IEC 60364-7-712 for photovoltaic installations.

CSP type of switch-disconnectors can meet all requirements of installation with rated operational voltage up to 1000V and operational currents up to 80A in utilization category DC21B.

Switch-disconnectors are designed to be placed between photovoltaic cells and DC/AC inverter.

- 設計精巧
- 依據 IEC 60947
- 防護等級 IP65
- DIN導軌或螺栓安裝

- Compact design
- According to IEC 60947
- Protection degree IP65
- DIN-rail or screw mounting

接線圖 / CONNECTION DIAGRAMS

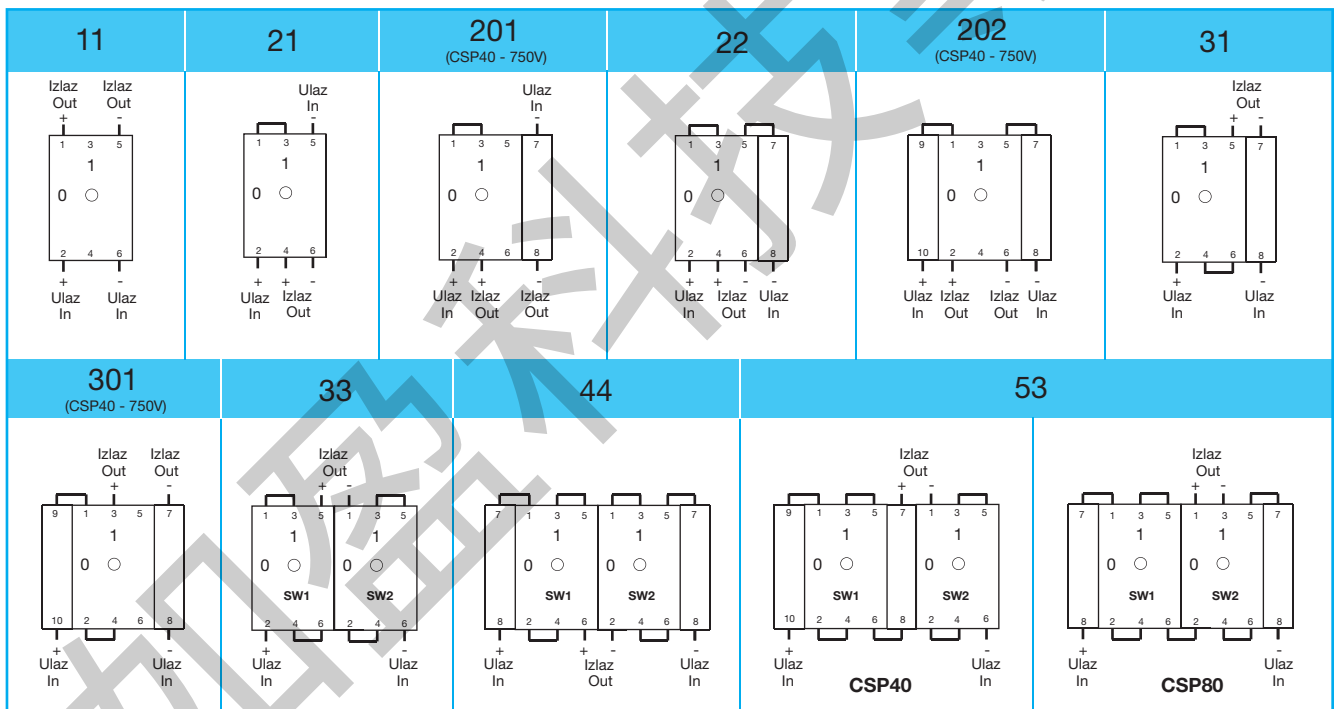

安裝輔助觸點 / INSTALLING AUXILIARY CONTACTS

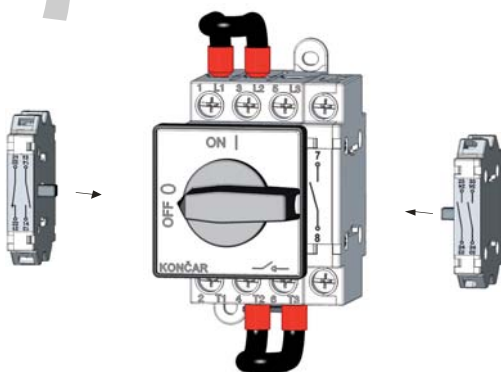

輔助觸點/ Auxiliary contacts

- 1n/o+1n/c
- 2n/o

配件需安裝於"0"之位置

Accessories must be mounted in position "0".

技術性資訊 / TECHNICAL DATA

額定操作電壓 Rated operational voltage U_e [V]	額定操作電流 Rated operational current I_e [A] DC21B	隔離開關之種類 Type of switch-disconnector	極數 Number of poles
220	40	CSP40-21	3
	50	CSP80-21	3
	80	CSP80-31 ili/or CSP80-22	4
450	7	CSP40-11	2
	16	CSP40-21	3
	30	CSP40-31 ili/or CSP40-22	4
	40	CSP40-33	6
	40	CSP40-44	8
	63	CSP80-31 ili/or CSP80-22	4
	80	CSP80-33	6
500	80	CSP80-44	8
	16	CSP40-21	3
	30	CSP40-31 ili/or CSP40-22	4
	35	CSP80-31 ili/or CSP80-22	4
	35	CSP40-33	6
	40	CSP40-44 ili/or CSP40-53	8
	50	CSP80-33	6
600	80	CSP80-44 ili/or CSP80-53	8
	12	CSP40-21	3
	18	CSP40-31 ili/or CSP40-22	4
	45	CSP80-33	6
750	65	CSP80-53 ili/or CSP80-44	8
	8	CSP40-201	3
	12	CSP40-301 ili/or CSP40-202	4
	35	CSP40-33	6
	40	CSP40-44 ili/or CSP40-53	8
	45	CSP80-33	6
1000	50	CSP80-44 ili/or CSP80-53	8
	16	CSP40-33	6
	20	CSP40-44 ili/or CSP40-53	8
	20	CSP80-33	6
	30	CSP80-44 ili/or CSP80-53	8

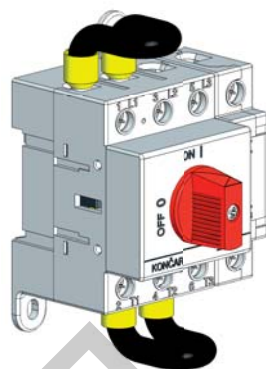

CSP80-31-40048D

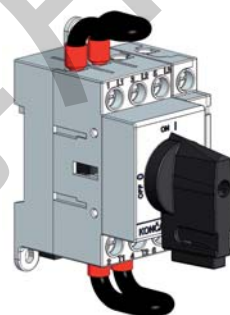

CSP40-31-O48D,56

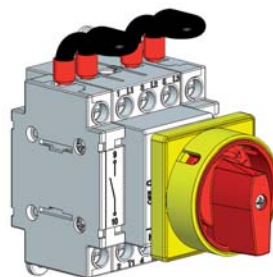

CSP40-202-40006

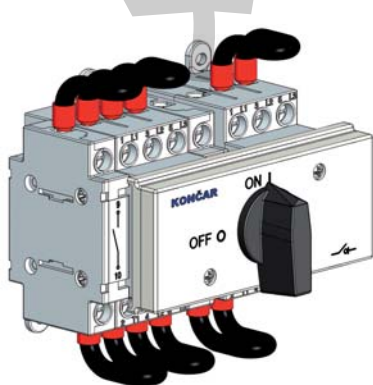

CSP40-53-O48D



CSP80-44-O



尺寸圖 / DIMENSIONAL DRAWINGS

底部安裝
REAR MOUNTING

接線圖 / connection diagrams
11,21,22,202,31,301

CSP40

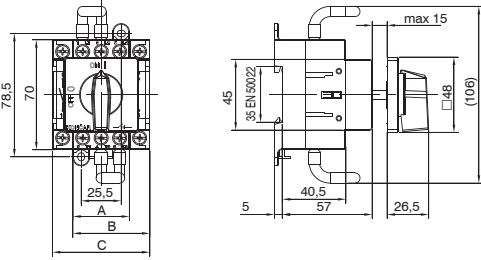

接線圖 / connection diagrams
33,44,53

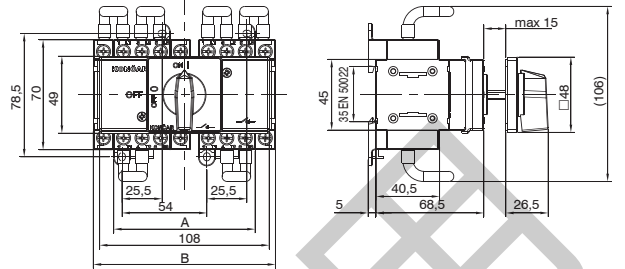

接線圖 / connection diagrams
21,22,31

CSP80

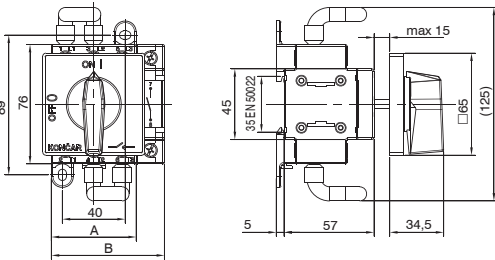

接線圖 / connection diagrams
33,44,53

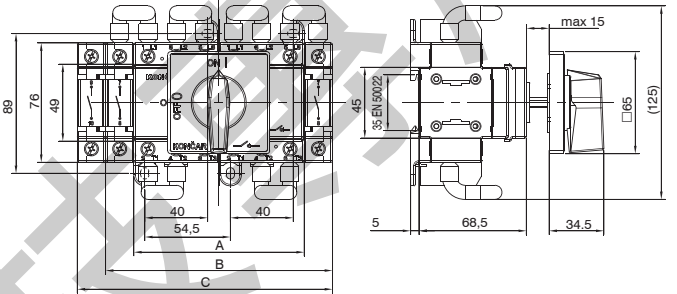

Tip / Type	CSP40					CSP80				
	11,21	22,31	202,301	33	44,53	21	22,31	33	44	53
A	36	-	-	90	-	54	-	108,5	-	-
B	-	49	-	-	116	-	72	-	144,5	-
C	-	-	62	-	-	-	-	-	-	162,5

鑽孔示意圖 / DRILLING PLAN

後面板
Rear plate

前面板
Front plate

接線圖 / connection diagrams
11,21,22,202,31,301

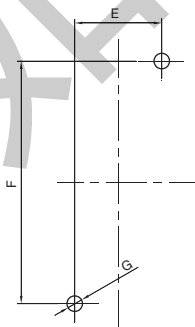

接線圖 / connection diagrams
33,44,53

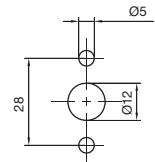
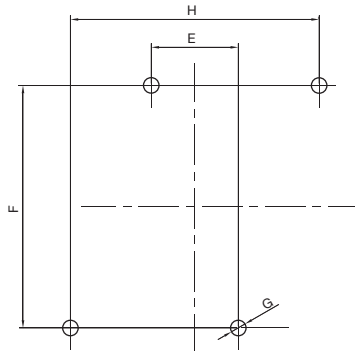

Tip / Type	E	F	G	H	
11,21,22,202,31,301	CSP40	25	78	4,5	-
	CSP80	40	88	5,5	-
33,44,53	CSP40	28	78	4,5	80
	CSP80	14	88	5,5	94